

Introducing

Care Finder™

from Quantum Health



Find high-quality, cost-effective care – all with a quick search

New to town and need a doctor? Out of town and need a doctor? Looking for the best place to get an MRI or have surgery? Now there's only one place you need to go for your healthcare research and it's as close as your computer or mobile device.

Found in your Quantum Health account, Care Finder helps you find and compare the cost and quality of healthcare providers and facilities so you can make informed choices about the care you'll receive. Checking cost and quality rankings in advance can save you hundreds or even thousands of dollars and ensure you receive the best possible care.



Search by doctor, facility or procedure, and your ZIP code. Always confirm with your provider that they are in-network when scheduling an appointment.

Cost Legend

Facilities are rated according to their cost, be sure to look for the green, Fair Price circle to ensure you do not overpay.

- At or below the Fair Price
- Slightly above the Fair Price
- Highest Cost

[Learn More](#)



Did you know that in-network prices for the same procedure can vary by over 500% depending on the facility you choose? Estimated costs for providers, facilities and procedures are based on the amount health plans have typically paid on claims in your area. The "Fair Price" is the amount you can reasonably expect the medical service to cost.

Cost Legend

Facilities are rated according to their cost, be sure to look for the green, Fair Price circle to ensure you do not overpay.

- At or below the Fair Price
- Slightly above the Fair Price
- Highest Cost

[Learn More](#)



The rankings reflect provider and facility performance across multiple criteria, including patient outcomes.

Quality Legend

Facilities are ranked according to their quality. Choosing a facility with the green, high quality circle will generally result in better outcomes for a selected procedure.

- Highest Quality
- Average Quality
- Lowest Quality



myselfbenefits.com

(855) 576-9984

(Monday-Friday, 8:30 a.m.-10 p.m. ET)



Quickly find quality care at a reasonable price.

When it comes to choosing a provider and a facility for common services – imaging, diagnostic procedures, outpatient surgery and more – you have options. With Care Finder, understanding your options is an easy, informative experience. **Always confirm the price and that your provider is in-network when scheduling an appointment.**

Go to Care Finder

1. Log on to your Quantum Health account.
2. Go to the **Care** page.
3. Select **Launch Care Finder**.
4. Begin your search.

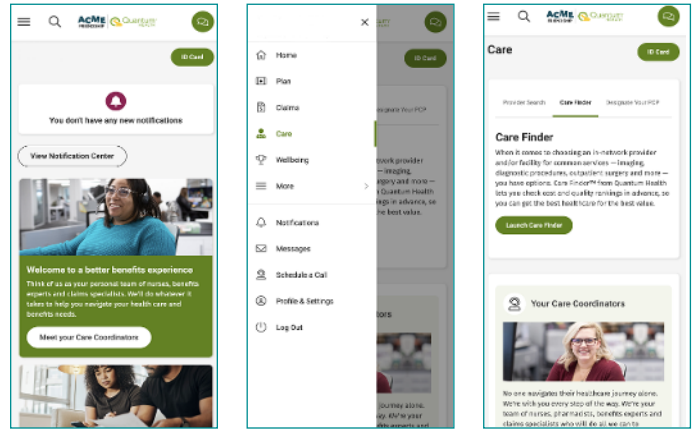

Search for providers and facilities

- Type in a search term or use the drop-down menus to find a particular service. Select the procedure you are looking for from the search results.
- Review the price range in your area and find the local Fair Price for your service. Prices are color coded. Green indicates that the price is at or below the Fair Price, yellow is slightly above the Fair Price, and red indicates the highest price.
- You'll find price rankings for doctors and facilities. Ranges are used rather than exact pricing in case additional services need to be provided at the appointment changing the overall cost.

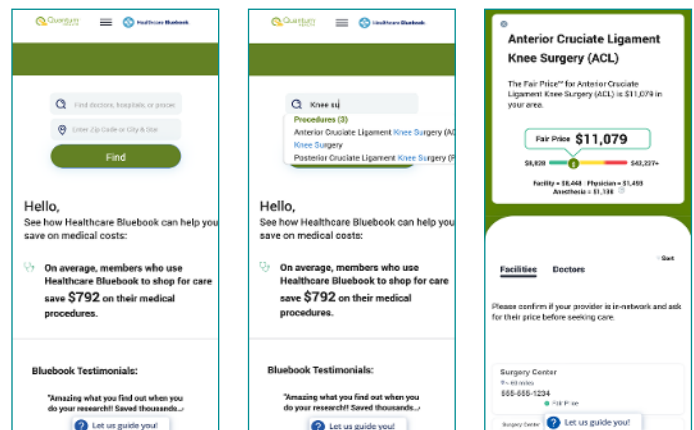

Compare cost and quality rankings

- Highest-quality, lowest-cost providers and facilities are shown first.
- Explore the details for each provider, including location, contact information and more.

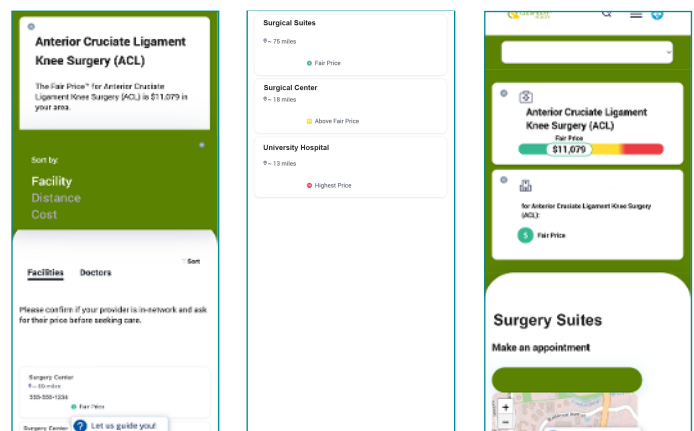

myseflbenefits.com

(855) 576-9984

(Monday-Friday, 8:30 a.m.-10 p.m. ET)

